



LICON^{MT}

modular machining centers

LIFLEX

- + HORIZONTAL MACHINING CENTERS
- + SINGLE AND TWIN SPINDLE
- + FOUR AND FIVE AXES

- + HORIZONTALE BEARBEITUNGSZENTREN
- + EIN- UND DOPPELSPINDLIG
- + VIER UND FÜNF ACHSEN



LOADING OPTIONS BELADEOPTIONEN

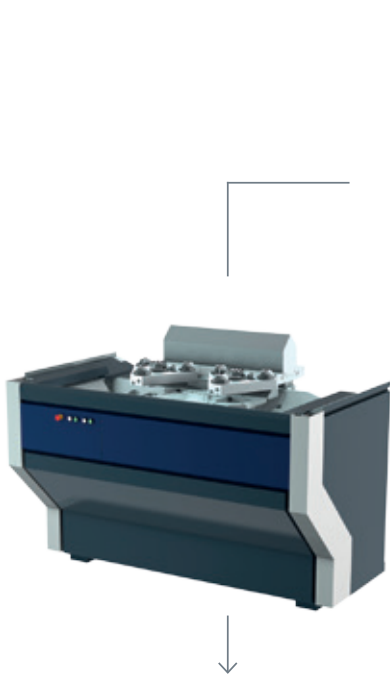

PALLET CHANGER PC
PALETTENWECHSLER PC

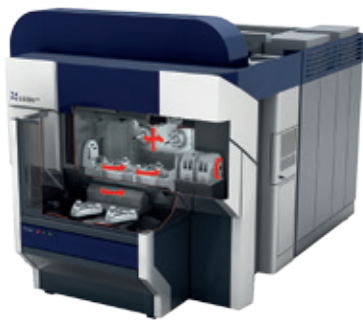

DIRECT LOADING DL
DIREKTBELADUNG DL



DOUBLE TRUNNION DT
DOPPELSCHWENKTRÄGER DT



MOTORIZED SPINDLES MOTORSPINDELN

85 Nm ... 500 Nm
HSK 63 + HSK 100
6000 + 8000 +
12000 + 16000 rpm



TRUNNIONS SCHWENKACHSEN

With 1 to 4 B-axes
Mit 1 bis 4 B-Planeten

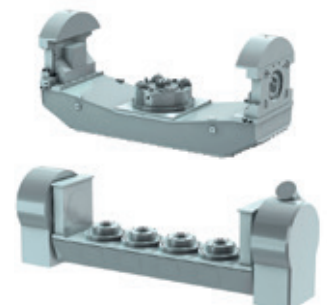

MACHINING CENTER LiFLEX II 1066 i

+ DOUBLE SPINDLE + HORIZONTAL + FIVE (5) AXES

Bearbeitungszentrum LiFLEX II 1066 i

+ DOPPELSPINDLIG + HORIZONTAL + FÜNF (5) ACHSEN

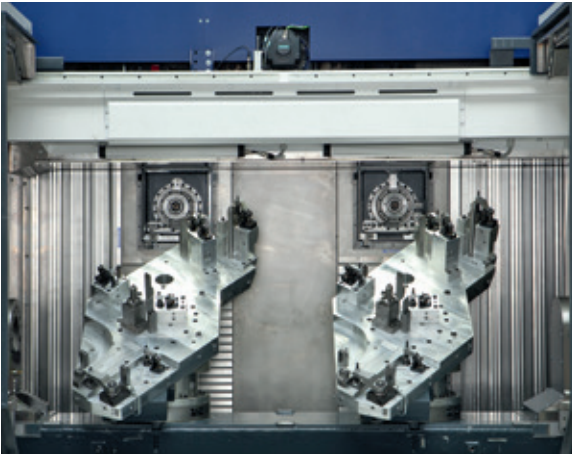

The new LiFLEX II 1066 extends the range of applications with the LiCON horizontal, double spindle machining centers. It covers now the entire range from 400 mm to 1050 mm spindle distance.

Large work pieces with a cubicle up to 1000 mm used to be machined only on single spindle mc in two clampings. With the LiFLEX II 1066 and 5 axes, it can be done in one clamping, two parts at the same time - efficient and cost saving.

> Ideal for structural parts i.e. cradles

Die neue LiFLEX II 1066 erweitert den Anwendungsbereich der horizontalen, doppelspindligen Bearbeitungszentren. Damit deckt LiCON den ganzen Bereich ab, von 400 mm bis 1050 mm Spindelabstand.

Große Werkstücke mit einem Kubus bis 1000 mm wurden bislang meist einspindlig und in zwei Aufspannungen bearbeitet. Mit der LiFLEX II 1066 und 5 Achsen geht es in nur einer Aufspannung – zwei Teile gleichzeitig- effizient und kostensparend.

> Ideal für Strukturbauteile

NEW



LiCON CUSTOMERS

LiCON KUNDEN

- AE Group
- Audi
- BMW
- Bosch
- Daimler
- FAW
- General Motors
- GF Georg Fischer
- Haldex
- Hitachi
- Honeywell
- Huizhong
- Jitong
- Linamar
- Magna
- Saint Jean
- Scania
- Schweizer Group
- TCG Unitech
- VW Volkswagen
- ZF

WORK PIECES

aluminum + magnesium + cast iron + forged steel
wet machining, minimum quantity lubrication (MQL),
dry machining

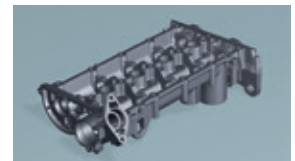
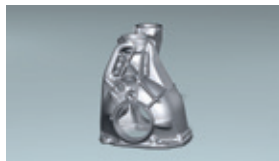

WERKSTÜCKE

Aluminium + Magnesium + Stahlguss + Schmiedestahl
Kühlmittel (KSS), Minimalmengenschmierung (MMS),
Trockenbearbeitung

FLEXIBLE ROTARY MACHINES

FLEXIBLE RUNDTAKTMASCHINEN



TURN KEY SOLUTIONS



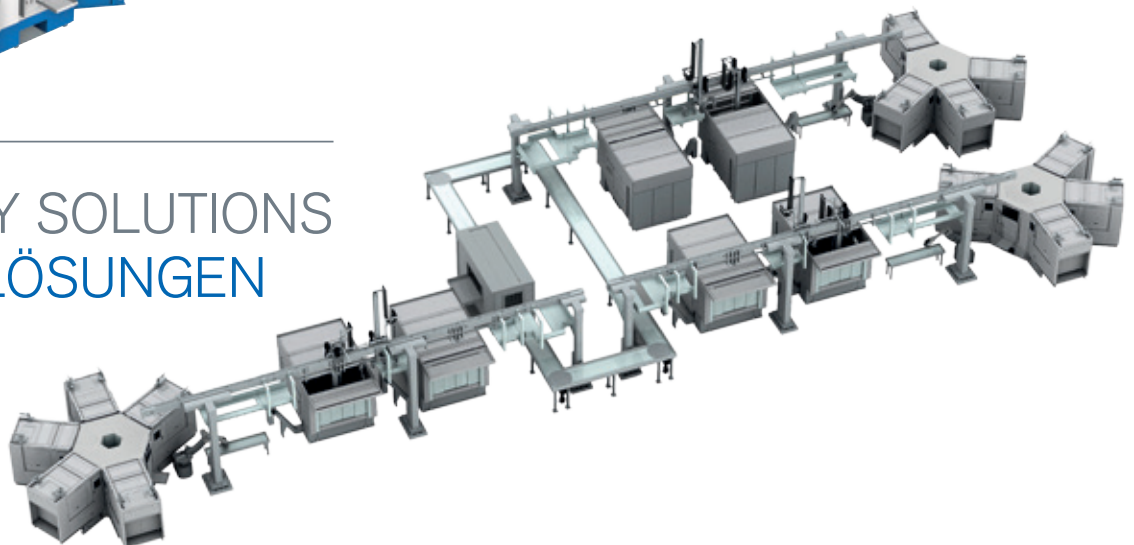





















GESAMTLÖSUNGEN



LiFLEX MACHINING CENTERS

LiFLEX BEARBEITUNGSZENTREN



MACHINE TYPE	LiFLEX I 744	LiFLEX I 1266	LiFLEX II 444	LiFLEX II 766	LiFLEX II 1066
Number of Spindles	1	1	2	2	2
Anzahl Spindeln					
Axes	4 axes / 5 axes	4 axes / 5 axes	4 axes / 5 axes	4 axes / 5 axes	4 axes / 5 axes
Achsen					
Spindle distance (mm)	-	-	450/400	750	1050
Spindelabstand (mm)					
Work travel (mm)	X=750 Y=470 Z=420	X=1200 Y=660 Z=650	X=450/400 Y=500/470 Z=420	X=750 Y=660 Z=650	X=1050 Y=660 Z=650
Arbeitshub (mm)					
i-Technology Independent Z Axes	-	-	i	i	i
i-Technologie Unabhängige Z Achsen					
i ³ -Technology Independent X, Y, Z Axes	-	-	-	i ³	i ³
i ³ -Technologie Unabh. X, Y, Z Achsen					
Spindle HSK	HSK 63 HSK 100	HSK 63 HSK 100	HSK 63 HSK 100	HSK 63 HSK 100	HSK 63 HSK 100
Spindel HSK					
Tool magazine 30 places			-	-	-
Werkzeugmagazin 30 Plätze					
Tool magazine 60 places					
Werkzeugmagazin 60 Plätze					
Tool magazine 120-240 places					
Werkzeugmagazin 120-240 Plätze					
Direct loading					
Direktbeladung					
Double trunnion	-	-			-
Doppelschwenkträger					
Pallet changer					
Palettenwechsler					



LiCON mt L.P.

2135 Bishop Circle Drive East,
Unit 1, Dexter, MI 48130
USA

Phone: +1.734.426.2240
info@licon.com



LiCON mt GmbH & Co. KG

Im Risstal 1
88471 Laupheim
Deutschland

Phone +49.7392.962.0
info@licon.com



LiCON mt Beijing

Room 1208 B Zone
No.122 Botai International Building
Nanhu Dongyuan Wangjing
Chaoyang District
Beijing, P.R. China

Phone: +86.10.6494-2043
info@licon.com



QUALITY PRODUCED IN GERMANY



LiCON mt GmbH & Co. KG

Headquarter Germany
Im Risstal 1
88471 Laupheim

Phone +49 7392 962 0
info@licon.com

WWW.LICON.COM